



sewoo

SEWOO TECH CO.,LTD.

Doosung BD, 689-20, Geumjung-dong, Gunpo-si, Gyeonggi-do, 435-862 South Korea

TEL : +82-31-459-8200 FAX : +82-31-459-8880

www.miniprinter.com



MODEL : LK-P31

MOBILE PRINTER



Disposal of Old Electrical&Electronic Equipment(Applicable in the European Union and other European countries with separate collection systems)

This symbol on the product or on its packaging indicates that this product shall not be treated as household waste.

Instead it shall be handed over to the applicable collection point for the recycling of electrical and electronics equipment. For more detailed information about recycling of this product, please contact your local city office, your household waste disposal service or the shop where you purchased the product.

Table of Contents

1. Unpacking	2
2. Product overview	3
3. Usage and Installation	4
3-1. Control panel usage	4
3-2. Battery Installation	5
3-3. Battery removal	6
3-4. Battery charging	7
3-5. Battery charger usage	8
3-6. Usage of Cigar Jack for charging	9
3-7. Roll paper installation	10
3-8. Printer Case Usage	11
38. Self test	12
4. Peripherals connection	14
4-1. Bluetooth connection	14
4-2. Interface cable connection	15
5. Printer specification	16
5-1. Specification	16

1. Unpacking

Standard



Printer

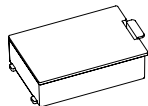

Battery

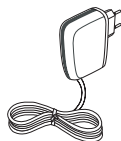

Charger

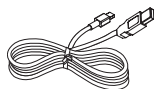

USB Cable Shielded

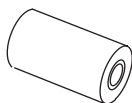

Roll paper



CD



Quick Manual

Optional



Battery Holder (Cradle)



Cigar Jack Charger

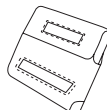

Case Usage

2. Product overview

Front

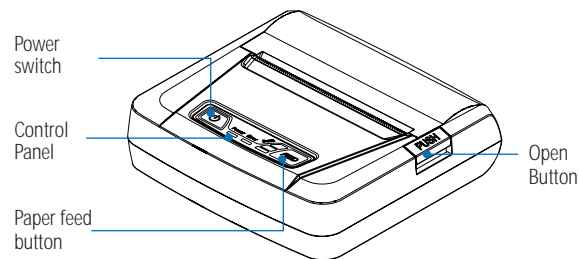



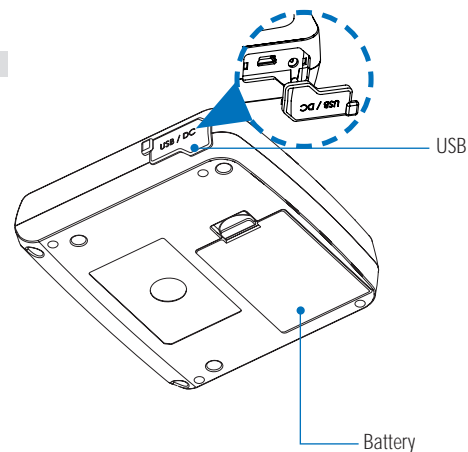

Rear

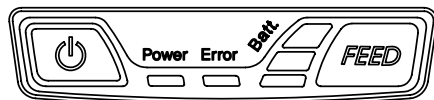

3. Usage and Installation

3-1 Control panel usage



Button	Name	function
	Power button	This button is used to turn the printer on and off. When the printer is off, press this button for approximately 3 seconds and it will turn on the power. When you press this button in a state that the printer is on, the printer will turn off.
	Paper Feed Button	Paper output can be done manually by pressing this button. Additionally, self-testing and Hexadecimal Dumping can be processed.. 1. Refer to "3-9" for self test information. 2. Refer to the service manual regarding Hexadecimal Dumping.
	Battery Status Lamp	1. If the Batt, LED are Lit, the battery is fully charged. 2. If you can hear beeping sound and LED light is turned off, it means that the battery is at the lowest level. 3. If the battery is not charged at all, the printer turns off automatically.
	Error Lamp	If the red light is turned on, it means there is no paper roll or the paper cover is open.

3-2 Battery Installation

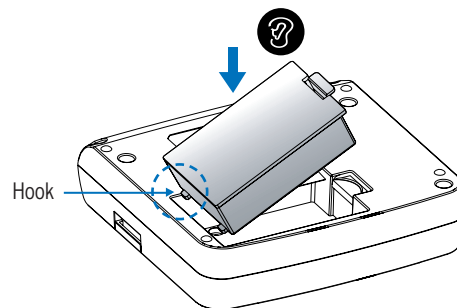

1. Align battery hook as shown in the picture
2. Push the battery into the printer until it locks in place.

NOTE

As the battery is not charged at the time of your purchase, charge the battery prior to using the printer
(Battery charger or Cradle can be used to charge)

CAUTION

Risk of explosion if battery is replaced by an incorrect type.
Dispose of used batteries according to the instructions

3-3 Battery removal

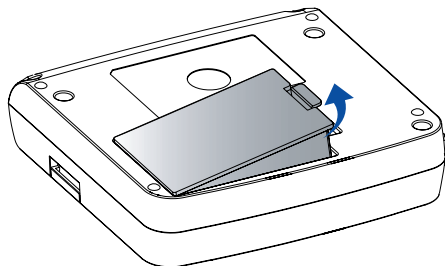

After putting up the belt clip, remove the battery holding it up as shown above.

3-4 Battery charging

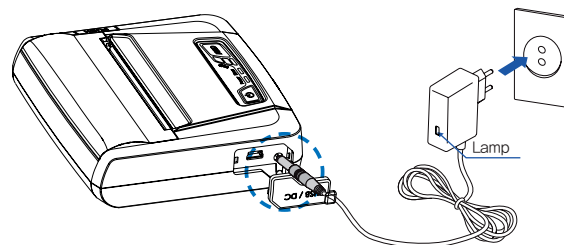

1. Be sure that the printer is turned off
2. After open the DC JACK cover, insert DC JACK into the printer.
3. Plug the power code to electrical outlet.

3-4-1 The status of lamp in charging

Status	charging	charging complete
Charging Lamp	Red	Green

✓ NOTE

1. Unless the exclusive charger is used provided by the manufacturer, the printer can be damaged, and the manufacturer is not liable for the consequential damage.
2. Before removing the battery, make sure that power is turned off.
3. Printer does not work in the status of being connected with charger only.
4. The battery should be installed to operate printer.
5. While charging, do not turn on the power.
6. Do not operate the print while charging the battery.
7. Do not connect the charger while the printer is operated.

3-5 Battery charger usage

Optional

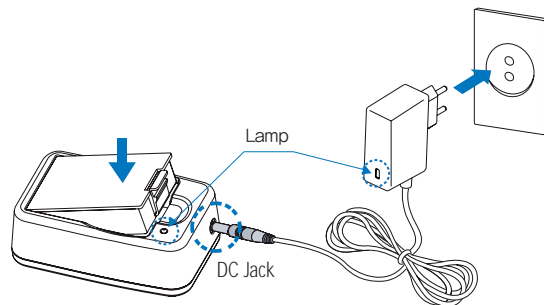

1. Insert the battery into the battery holder as shown above
2. Connect the DC JACK to the power electrical outlet.
3. Plug the power code into the electrical outlet.
4. Once the charging is completed, remove the battery from the holder.

3-5-1 The status of lamp in charging

Status	charging	charging complete
Charging Lamp	Red	Green

NOTE

In the case the battery is not fixed properly in the holder, the red lamp will be blinking. Then, extract and reinsert the battery.

3-6 Usage of Cigar Jack Charger for charging

Optional

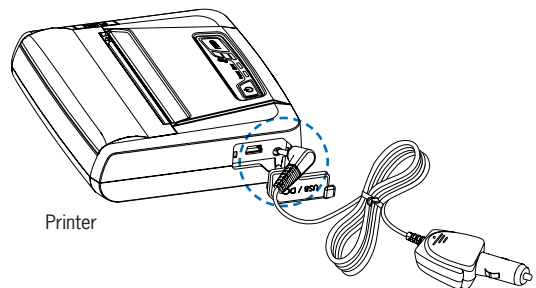

Printer

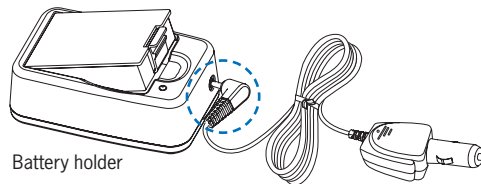

Battery holder

Connect the car cigar JACK charger into the printer or battery holder.

Input	12 ~ 24V
Output	8.4V 0.8 ~ 1.2A

NOTE

Use the Cigar Jack offered by the manufacturer.

3-7 Roll paper installation

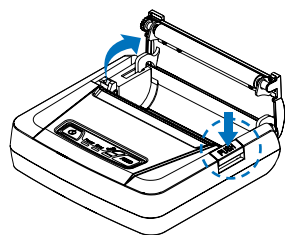

Press the PUSH button to open the paper cover

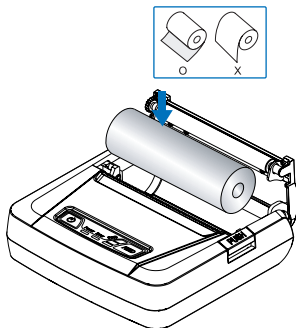

Insert the paper in the right direction

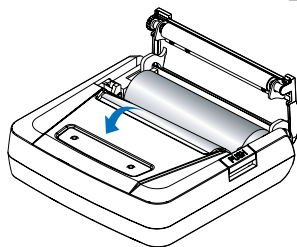

Pull a short length of paper out of the printer and close the cover.

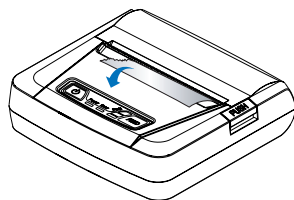

Tear off the additional paper using tear bar.

1 2
3 4

3-8 Printer Case Usage

Optional

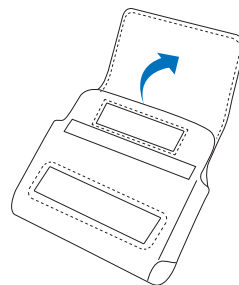

Open the Velcro.

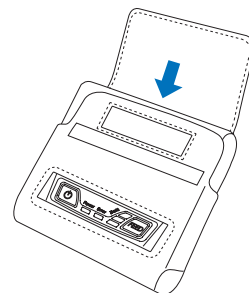

Put the printer into the case following the direction as shown in the picture.

1 2
3 4

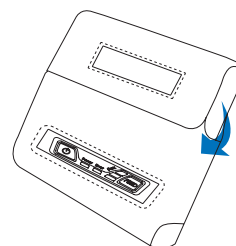

Close the Velcro.

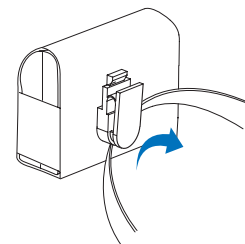

Fix this case to the belt with using the belt buckle.

3-9 Self Test

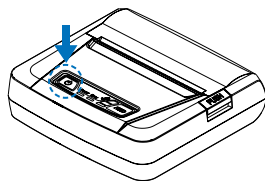

Turn off the power pressing the power button for approximately 3 seconds.

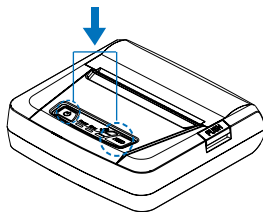

While you are pressing the FEED button, press the power button

1 2
3

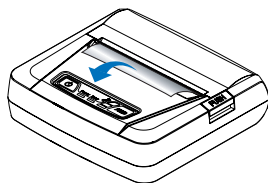

The printout is produced.

NOTE

1. To print ASCII pattern additionally, press the Feed button once more
2. After printing ASCII pattern, the self test will be finished automatically.
3. If the Feed button is not pressed to print ASCII pattern, self test will be finished automatically after 30 seconds.

The sample of self test printout

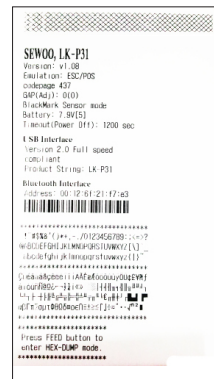

When the printer is installed initially or when you face a problem, you can run the self test and check the information about

-Control Circuit, Mechanism, Print Quality, ROM Version

After checking with self-test and no issues are found, you can examine other devices and software. This function is working independent of devices and software.

● Motor protection from being overheated

The motor should be stopped and cooled about more than 30 seconds after continuous printing 1.5 meter

4. Peripherals connection

This printer can communicate with Peripherals device via Bluetooth and cables.

4-1 Bluetooth Connection

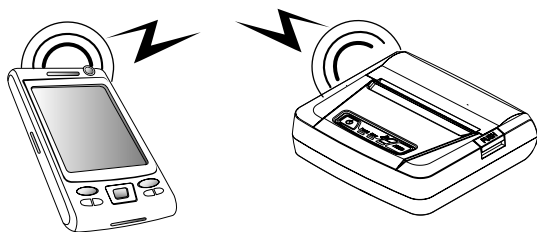

1. Printer can be connected to the PDA and PC which can do wireless communication.
2. By using Bluetooth function supported in PC, printer can be connected.

✓ NOTE

Refer to the Bluetooth Manual for more details on connection.

4-2 Interface Cable Connection

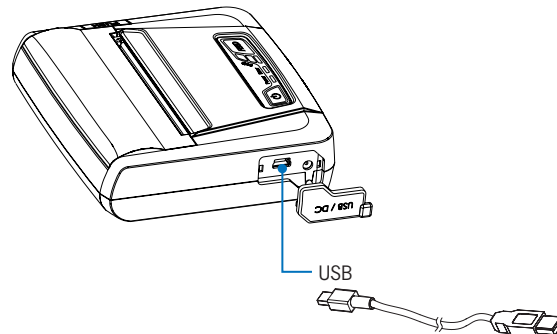

1. Connect USB into the cable connector on the printer.

✓ NOTE

Use the cable offered by the manufacturer (USB)

2. Connect the interface cable into the USB port of the device (PDA, PC, etc.)

5. Pritner Specification

5-1 Specification

Printing Method		Direct Thermal
Printing Speed		60mm/sec
Resolution		203 DPI X 203 DPI
Character		Font A (12X24), Font B (9X17)
Character per line		Font A : 48pt , Font B : 64pt
Character set		ALPHA NUMERIC Character, Extension Character
Barcode		EAN-8, EAN-13, Code39, ITF, UPC-A, Codabar, Code93, Code128
Emulation		ESC/POS Command compatible
Driver		Windows printer driver(7, XP, 2000, 2003, VISTA, 32 & 64bit), Windows(CE 4.2 & 5.0 / Mobile 5.0~), Linux printer driver, Symbian, Blackberry, Android(2.1~)
Sensor		Paper End Sensor , Cover Open Sensor , Black Mark Sensor
Paper	paper type	Thermal Paper
	width	79.5mm+/-0.5mm
	thickness	0.065mm
	External Diameter	Max. ϕ 25mm+/-0.5mm
	Internal Diameter	8.5mm +/-0.5mm
Reliability	TPH	50km
	Battery	Continuous Printing 40~50min Standby: 16Hrs
Communications		USB, Bluetooth Class2

Battery Charger	input	AC100~240V, 50/60Hz
	output	8.4V , 800~1400mA
	Charging time	2.5Hrs
Battery	Battery type	Li-ion
	output	7.4V, 1130mAh
Size	W X D X H(mm)	110 X 105 X 30
	W X D X H"	4.3 X 4.1 X 1.2
Weight		310g
Environmental sealing		IP42
Temperature	operation	-10 ~ 50℃
	storage	-20 ~ 60℃
Humidity	operation	35 ~ 95%
	storage	10 ~ 95%

