

Graupner

No. 7906

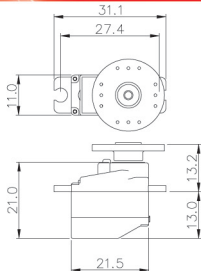

SERVO



Technische Daten

Stellmoment/4,8 V, ca.	8 Ncm
Stellmoment/6,0 V, ca.	10 Ncm
Stellzeit/4,8 V, ca.	0,065 Sek./40°
Stellzeit/6,0 V, ca.	0,05 Sek./40°
Gewicht, ca.	8,5 g

Specification

Torque/4,8 V, approx.	8 Ncm
Torque/6,0 V, approx.	10 Ncm
Speed/4,8 V, approx.	0,065 Sec./40°
Speed/6,0 V, approx.	0,05 Sec./40°
Weight, approx.	8,5 g

DES 291 BB MG

Made in Korea **PN.PE-01**

GRAUPNER GmbH & Co. KG · D-73230 KIRCHHEIM/TECK · www.graupner.de